



*"Together in God's grace,
may we give our children the
roots to grow and the wings
to fly"*

Loughborough CofE Primary
School, William Street, LE11
3BY

Tel: 01509 263430

Email:

office@lceps.risemat.co.uk

Website:

[https://www.loughborough-
primary.co.uk/](https://www.loughborough-primary.co.uk/)

Twitter: @LoughboroughCE

Loughborough CofE Primary School
19th April 2024

Newsletter 12

Great news! I am really excited to announce that our new EYFS classroom is now completed. Yesterday we had a small opening ceremony as the building was officially handed over to us from the contractor. As you can see from the pictures attached it looks amazing and the contractors have done a fantastic job.

We are looking forward to being able to use it for the first time in the Autumn term and can't wait for our new EYFS pupils to join us in their brand new classroom. I know that Miss Elverson and Mrs Downs are keen to get in there and make it look even more amazing than it does already.

Our current EYFS children will remain in the original EYFS classroom until the end of the year.

During the summer break the contractors will return to Loughborough C of E and will be demolishing the old EYFS building. We will then begin putting the plans of our school council into action by creating a planting and garden area as well and using the canopy as a covered seating area on the playground. Our school grounds will look very different when we return to school next academic year.

Now that the building works are complete and the security fencing is removed, it is safe for us to use the playground gate near to the tyre park to drop pupils off in the morning and collect at the end of the day. We will revert to using this system from Monday 22nd April. The gate will open and close at the usual times.

Thank you as always for your continued support.

Mrs Ferey

Weekly Attendance

EYFS	97.3%
Yr 1	94.8%
Yr 2	95.4%
Yr 3	96.3%
Yr 4	95.6%
Yr 5	93.2%
Yr 6	97.6%

Year to Date Attendance

EYFS	98.3%
Yr 1	93.8%
Yr 2	94.5%
Yr 3	94.8%
Yr 4	93.9%
Yr 5	93.2%
Yr 6	95.4%

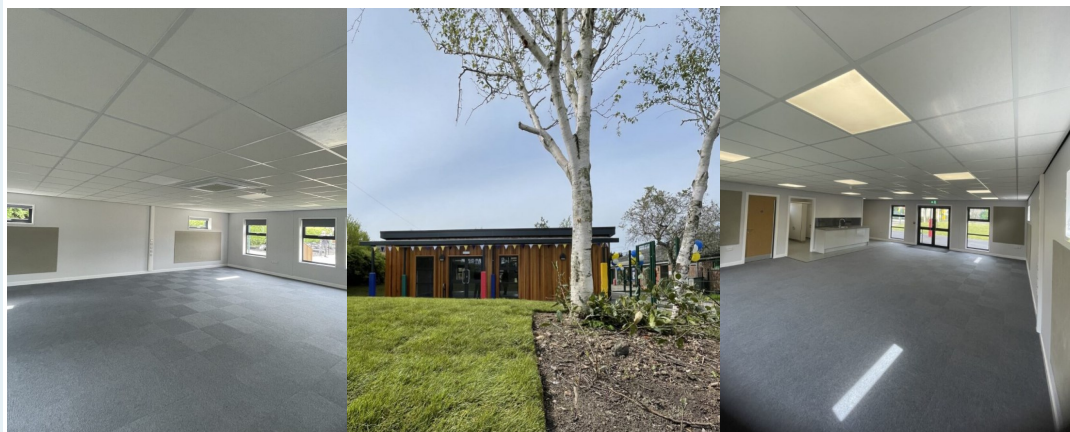

At Loughborough C of E we use our conduct posters to promote exceptional behaviour and high expectations:

FIRST TIME

- 1 FIRST TIME
- 1 EVERY TIME
- 1 EVERYWHERE
- 1 EVERYONE

BE A STAR

- ↑ SIT UP
- 👁️ TRACK THE SPEAKER
- ❓ ANSWER QUESTIONS
- 🤝 RESPECT OTHERS

STEP

- 🗨️ SPEAK POLITELY
- 👍 THANK YOU
- 👉 EXCUSE ME
- 🙏 PLEASE

SHAPE

- 📄 SENTENCES
- 👉 HANDS DOWN
- 🗨️ ARTICULATE
- 📢 PROJECT
- 👁️ EYE CONTACT

FANTASTIC WALKING

- ↑ FACING FORWARDS
- 👉 ON THE LEFT
- 👉 HANDS BY SIDE
- 📢 STEADY PACE
- 🚫 NOT TALKING

Conkers Trip

On Tuesday, Year 1 and 2 ventured to Conkers Discovery Centre to enhance their learning in Science and Geography. We watched a 4d cinema clip which helped us learn about how plastic and rubbish hurts the environment and the animals in it. We then went on a treasure trail where we had to find letters placed around the lake to discover a special word. Year 1 enjoyed learning all about how seeds are spread, ready for their next Science unit and Year 2 consolidated their learning on habitats by searching for bugs in their habitats. We were even brave enough to go over a really high bridge on our treasure trail!



Polite notice

At Loughborough C of E Primary School we believe staff, parents and children are entitled to a safe and protective environment in which to learn and work. We ask that all members of the school community treat each other with respect and adults set a good example to children at all times, showing them how to get along with all members of the school and the wider community.

It is our expectation that no members of staff, parents or children are the victims of abusive behaviour or open to threats from other adults on the school premises. Physical attacks and threatening behaviour, abusive or insulting language verbal or written, to staff, governors, parents, carers, children and other users of the school premises will not be tolerated.



Diary Dates

2024	Who?	What?
29/04	Yr 4	Rise Voices - Choral Event
06/05	All	Bank Holiday school closed
07/05	All KS2	M&M Theatre production
W/C 13/05	Yr 6	Year 6 SATs week
17/05	All	Year 4 Class Assembly
24/05	All	Break the rule day School closes
03/06	All	School re-opens
W/C 10/06	Yr 1	Phonics screening
11/06	All KS2	Free School Trip to Go Ape (More information to follow)
21/06	All	EYFS Class Assembly
02/07	All Drama Club	Sports Day Drama club performance 5pm
03/07	Yr 6	Warning Zone Trip
04 & 05/07	Yr 6	Transition days
05/07	All	School move up day
08/07	All	Yr 6 Leavers service @ Emmanuel
09/07	All	School closes
27/08	All	School re-opens